



G100 CHAIN & FITTINGS

LIFTING YOUR BUSINESS TO A HIGHER LEVEL

AUSTRALIAN LIFTING CENTRE PTY LTD

1300 100 120

www.austlift.com.au



G100 Chain & Fittings

G100 Alloy Chain	10
Master Link	10
Master Link Multi	11
Chain Connector	11
Grab Hook (Clevis, Eye)	12
Self Locking Hook (Clevis, Eye, Swivel)	13
Sling Hook (Clevis, Eye)	14
Shortening Clutch (Clevis)	15
Spare Parts	16
Chain Sling WLL Tag	16

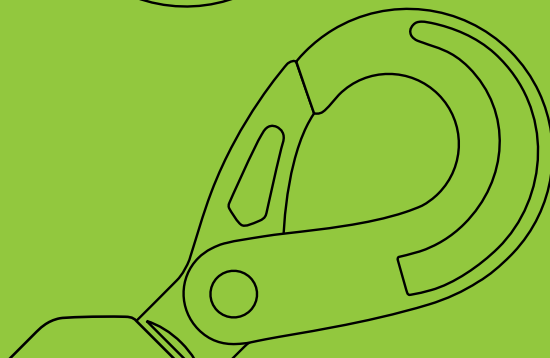
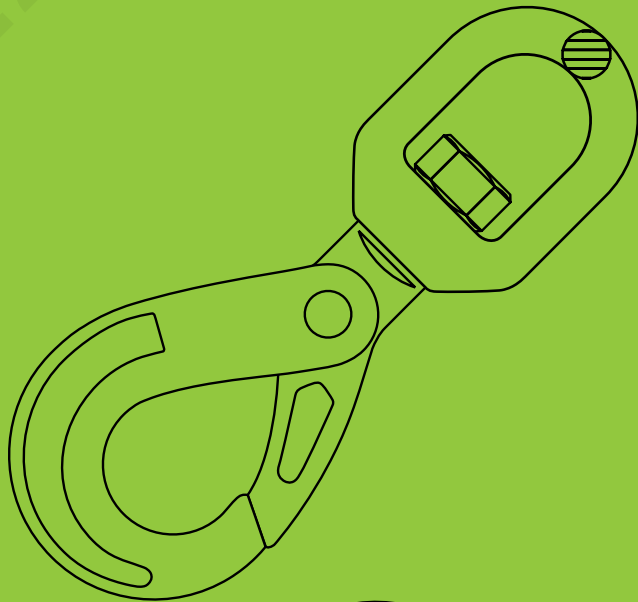



G100 Chain & Fittings

Austlift G100 products are manufactured and tested to the requirements of Australian Standard 2321 'short link chain for lifting purpose' and AS3776 'lifting components for Grade V chain slings' in extremely high quality.

All G100 products are made from alloy steel, the chemical composition conforms to EN1677:2000 specification. They are quenched and tempered, uniformly marked with equivalent chain size, grade, batch number, manufacturer's ID and product 'type code' for positive identification.

We regard your safety as our priority. Destructive tests are applied to every batch on a random sampling. Test certificates are available upon request.



Full Member

G100 Alloy Chain

Austlift G100 chain has a 25% higher lifting capacity than G80. The chain is manufactured from hardened and tempered alloy steels and has a high resistance to impact and wear to meet critical requirements of AS 2321 "short link chain for lifting purposes", but with 25% higher work load limit.

Chain links are formed to produce its high quality of strength, durability and safety of lifting chain applications.

- Marked with chain grade and traceability mark.
- Made of G100 alloy steel with safety factor of 4 to 1.

AS/NZS 2321	Certified	G100 Alloy Steel	Safety Factor 4-1	Size from (mm) 8-22
------------------------	------------------	-----------------------------	------------------------------	--------------------------------

SIZE (mm)	WLL (T)	DRUM		CUT LENGTH (1M)		DIMENSIONS (mm)		
		CODE	LENGTH (M)	CODE	Wt. (kg)	B	C	D
8	2.5	171108	350	171008	1.4	28	24	8
9	3.22	171109	250	171009	1.849	31.5	27	9
10	4	171110	250	171010	2.2	35	30	10
13	6.7	171113	130	171013	3.8	46	39	13
16	10	171116	100	171016	5.7	56	48	16
20	16	171120	60	171020	9	70	60	20
22	19	171122	25	171022	10.9	78	66	22

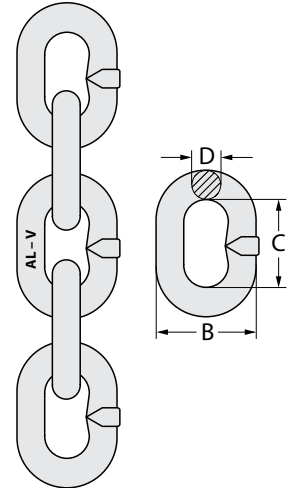

G100 Master Link (Type SD, with flat)

Austlift SD type G100 head-rings are designed to cater for single leg and double leg chain sling or wire rope sling applications.

- Marked with single and double chain sizes, designation, grade, manufacture quality mark and Austlift branded.
- 25% higher work load limit than G80 alloy chain.
- Batch Tested. Test certificates available upon request.
- Fatigue tested > 20,000 times.

AS/NZS 3776	Certified	G100 Alloy Steel	Safety Factor 4-1	Size from (mm) 6-22
------------------------	------------------	-----------------------------	------------------------------	--------------------------------

SIZE (mm)		CODE	WLL (T)	Wt. (kg)	DIMENSIONS (mm)		
1 LEG	2 LEG				A	B	D
8	6	170008	2.5	0.4	120	70	13
10	8	170010	4.3	0.7	140	80	17
13	10	170013	6.9	1.5	160	95	22
16	13	170016	11.6	2.51	180	100	27
20	16	170020	17.3	5.1	240	140	32
22	20	170022	27.7	7.2	250	150	38

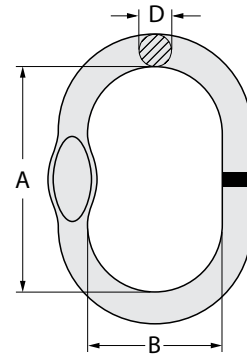

* Specification Chart for master Link WLL is 60 ° Angle for multi leg.

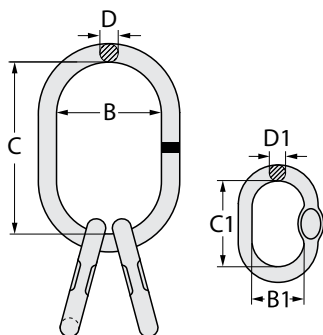

G100 Master Link Multi (Type MD, with flat)

Austlift MD type G100 multi head rings are designed with a large ring and two intermediate links to cater for two, three and four leg chain sling or wire rope sling applications.

- Marked with single and double chain size, designation, grade, manufacture quality mark and Austlift branded.
- 25% higher work load limit than G80.
- Batch tested, test certificates available upon request.
- Fatigue tested > 20,000 times.

AS/NZS 3776 Certified G100 Alloy Steel Safety Factor 4-1 Size from (mm) 6-16

SIZE (mm)	CODE	WLL (T)	Wt. (kg)	DIMENSIONS (mm)					
				B	C	D	B1	C1	D1
6	170106	3.5	1.8	90	150	19	70	120	14
8	170108	5	3.0	95	160	22	80	140	17
10	170110	8	6.5	120	200	30	95	160	22
13	170113	14	15	150	250	40	110	190	25
16	170116	21	23	200	300	50	120	200	32

G100 Chain Connector (Type CL) Hammerlock / Coupler/ Connector Link

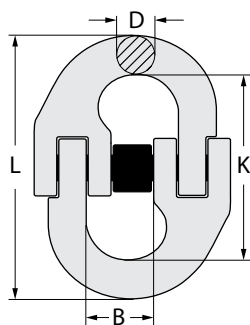

Austlift CL type G100 chain connector are commonly used to connect head rings, chain, hooks and other lifting components for chain slings.

- Marked with chain size, designation, grade, manufacture quality mark and Austlift branded.
- 25% higher work load limit than G80.
- Batch tested, test certificates available upon request.
- Fatigue tested > 20,000 times.

Refer to page 16 for G100 spare parts information.

AS/NZS 3776 Certified G100 Alloy Steel Safety Factor 4-1 Size from (mm) 6-22

SIZE (mm)	CODE	WLL (T)	Wt. (kg)	DIMENSIONS (mm)			
				B	K	D	L
6	170206	1.4	0.1	14	44.5	7.6	60
8	170208	2.5	0.22	18.5	61.5	10	84.5
10	170210	4	0.45	23	72	12.6	97.2
13	170213	6.7	1.15	27.5	89	16.8	127
16	170216	10	1.75	33.5	103	21	145
20	170220	15.6	2.7	42	116	24.5	175
22	170222	19	4.02	48	135	27	193

G100 Grab Hook (Clevis Type, GC)

Austlift GC type G100 clevis grab hooks provide the flexibility to shorten chain leg on a sling may also be used for back-hooking. Grab hooks come with supporting lugs to allow no reduction of the working load limit. The clevis is designed for ease of connection of chain.

- Marked with chain size, designation, grade, manufacture quality mark and Austlift branded.
- 25% higher work load limit than G80.
- Batch tested, test certificates available upon request.
- Fatigue tested > 20,000 times.

Refer to page 16 for G100 spare parts information.

AS/NZS 3776 Certified G100 Alloy Steel Safety Factor 4-1 Size from (mm) 6-22

SIZE (mm)	CODE	WLL (T)	Wt. (kg)	DIMENSIONS (mm)					
				A	B	C	D	W	L
6	170306	1.4	0.22	75	8	32	7.5	43.5	46
8	170308	2.5	0.34	91.5	10.8	36	9.5	53	66
10	170310	4	0.82	126	13.5	46	12	72	74
13	170313	6.7	1.75	136.5	16.5	59	15	96	97
16	170316	10	2.88	183.5	19.2	70	17.5	112.5	124
20	170320	16	4.84	224	24	85	24	143	150
22	170322	19	8.3	262	27	100	27	160.5	170

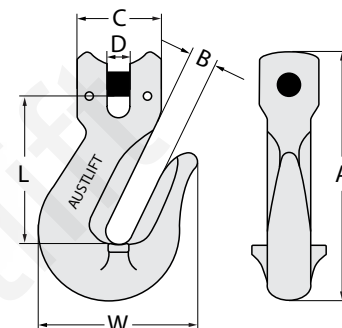

G100 Chain & Fittings

G100 Grab Hook (Eye Type, GE)

Austlift GE type G100 eye grab hook provide the flexibility to shorten chain leg on a sling may also be used for back-hooking. Grab hooks come with supporting lugs to allow no reduction of the working load limit. The eye is designed for ease of connection of coup-link.

- Marked with chain size, designation, grade, manufacture quality mark and Austlift branded.
- 25% higher work load limit than G80.
- Batch tested, test certificates available upon request.
- Fatigue tested > 20,000 times.

AS/NZS 3776 Certified G100 Alloy Steel Safety Factor 4-1 Size from (mm) 6-22

SIZE (mm)	CODE	WLL (T)	Wt. (kg)	DIMENSIONS (mm)				
				D	E	M	L	L1
6	170406	1.4	0.2	14.5	8	43.5	70	50.5
8	170408	2.5	0.28	18	10.8	53	91	73
10	170410	4	0.72	22.5	13.5	42	126	84
13	170413	6.7	1.6	28	16.5	96	162	104
16	170416	10	2.45	36	19.2	112.5	182	130
20	170420	16	4.72	43.5	24	143	225	152
22	170422	19	8.2	48.5	27	160.5	259	184

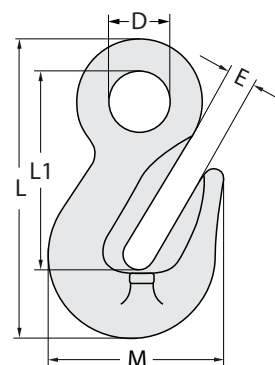

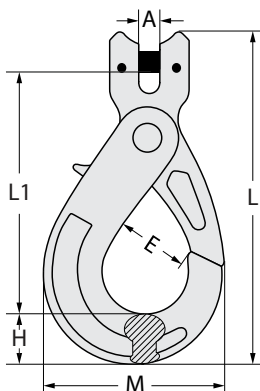

G100 Self Locking Hook (Clevis Type, LC)

Austlift LC type G100 clevis self-locking hook allows the hook to be easily closed with one hand, it will close itself when the load is engaged. The hook will not open until the trigger at the back is pressed. Clevis style allows easy connection to the chain.

- Marked with chain size, designation, grade, manufacture quality mark and Austlift branded.
- 25% higher work load limit than G80.
- Batch tested, test certificates available upon request.
- Spare trigger kits and load pins are available.
- Fatigue tested > 20,000 times.

Refer to page 16 for G100 spare parts information.

AS/NZS 3776 Certified G100 Alloy Steel Safety Factor 4-1 Size from (mm) 6-22

SIZE (mm)	CODE	WLL (T)	Wt. (kg)	DIMENSIONS (mm)					
				A	E	H	L	L1	M
6	170506	1.4	0.5	7.5	28	20	131	96	70
8	170508	2.5	0.9	9.5	35.5	26	166	123	90
10	170510	4	1.6	12	45	30	196.5	144	109
13	170513	6.7	2.9	15	53.5	40.5	251	182	138.5
16	170516	10	5.8	17.5	62	50.5	303	217	170.5
20	170520	16	8.6	25	76.5	62	337.5	235	192.5
22	170522	19	12.1	25.5	80	66	391	276.5	205

G100 Self Locking Hook (Eye Type, LE)

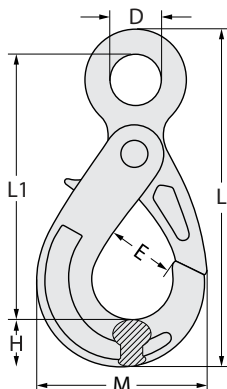

Austlift LE type G100 eye self-locking hook allows the hook to be easily closed with one hand, it will close itself when the load is engaged. The hook will not open until the trigger at the back is pressed. Eye style allows easy connection to links, shackles and wire.

- Marked with chain size, designation, grade, manufacture quality mark and Austlift branded.
- 25% higher work load limit than G80.
- Batch tested, test certificates available upon request.
- Fatigue tested > 20,000 times.

Refer to page 16 for G100 spare parts information.

AS/NZS 3776 Certified G100 Alloy Steel Safety Factor 4-1 Size from (mm) 6-22

SIZE (mm)	CODE	WLL (T)	Wt. (kg)	DIMENSIONS (mm)					
				D	E	H	L	L1	M
6	170606	1.4	0.5	21	28	20	141	110	70
8	170608	2.5	0.9	27	35.5	26	175	137	90
10	170610	4	1.5	34.5	45	30	212.5	169	108
13	170613	6.7	2.7	40	53.5	40.5	270	209	138.5
16	170616	10	5.7	50	62	50.5	331	254	170.5
20	170620	16	7.9	60	76.5	62	369	277	192.5
22	170622	19	11.2	70	80	66	417	319.5	205

G100 Self Locking Hook (Swivel Type, LS)

Austlift Grade 100 Swivel Self-locking Hook has a ball bearing swivel to allow the hook to swivel thus reducing the twist of a sling.

- Marked with chain size, designation, grade, manufacture quality mark and Austlift branded.
- 25% higher work load limit than G80.
- Batch tested, test certificates available upon request.
- Spare trigger kits are available.
- Fatigue tested > 20,000 times.

Refer to page 16 for G100 spare parts information.

AS/NZS 3776 Certified G100 Alloy Steel Safety Factor 4-1 Size from (mm) 6-22

SIZE (mm)	CODE	WLL (T)	Wt. (kg)	DIMENSIONS (mm)							
				B	C	D	E	H	M	L	W
6	173706	1.4	0.67	13	37	27	30	32	163	196.5	70
8	173708	2.5	1.21	15	41	35.5	40	39	202	243	90
10	173710	4	2.2	17.5	48	45	48	48	244	289	108
13	173713	6.7	4.4	19	55	52.5	63	57	292	351	138
16	173716	10	7.48	26	62	62	75	62	346	422	170
20	173720	16	13.75	28.5	76	76	80	72	396	487	191
22	173722	19	18.81	33	97	79	95	97	465	563	208

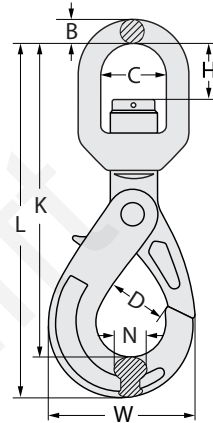

G100 Chain & Fittings

G100 Sling Hook (Clevis Type, SC, with Latch)

Austlift SC type G100 clevis sling hook are a general purpose hook suitable for most sling applications and comes with a cast latch for added safety. Clevis allows easy connection to chain.

- Marked with chain size, designation, grade, manufacture quality mark and Austlift branded.
- 25% higher work load limit than G80.
- Batch tested, test certificates available upon request.
- Fatigue tested > 20,000 times.

Refer to page 16 for G100 spare parts information.

AS/NZS 3776 Certified G100 Alloy Steel Safety Factor 4-1 Size from (mm) 6-22

SIZE (mm)	CODE	WLL (T)	Wt. (kg)	DIMENSIONS (mm)						
				A	B	E	H	M	L	L1
6	170806	1.4	0.33	7.5	32	18.5	21	68.5	109	85
8	170808	2.5	0.7	9.5	37	25	27.5	88	134	94
10	170810	4	1.3	12	48	28	33.5	105.5	161.5	120
13	170813	6.7	2.3	15	59	38	42	134	203	145
16	170816	10	3.6	17.5	70	44	50	160.5	248	170
20	170820	16	7.3	25	85	52	56	190.5	297	216
22	170822	19	12.1	27	100	66	62	214.5	326	252

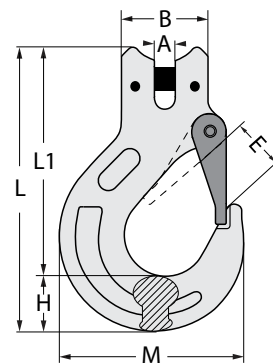

G100 Sling Hook (Eye Type, SE, with Latch)



Austlift SE type G100 eye sling hooks are a general purpose hook suitable for most sling applications and come with a cast latch for added safety. Eye allows easy connection to coup links and can be attached to lifting apparatus.

- Marked with chain size, designation, grade, manufacture quality mark and Austlift branded.
- 25% higher work load limit than G80.
- Batch tested, test certificates available upon request.
- Fatigue tested > 20,000 times.

Refer to page 16 for G100 spare parts information.

AS/NZS 3776 Certified G100 Alloy Steel Safety Factor 4-1 Size from (mm) 6-20

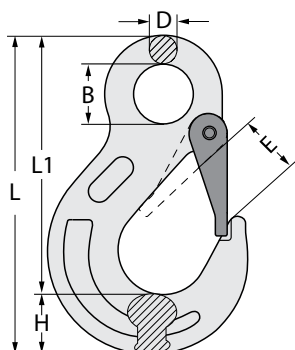

SIZE (mm)	CODE	WLL (T)	Wt. (kg)	DIMENSIONS (mm)					
				B	D	E	H	L	L1
6	170906	1.4	0.32	20.5	10	18.5	21	111	80
8	170908	2.5	0.6	25	11	25	27.5	137.5	99
10	170910	4	1.2	34	16	28	33	171.5	106
13	170913	6.7	2.2	43	19	38	43.5	219	156
16	170916	10	3.5	50	24.5	44	50	260	186
20	170920	16	7.15	55	27	52	56	298	215



G100 Shortening Clutch (Clevis Type, CC, safety pin)

Austlift CC type lockable clutches have the advantage of shortening a chain sling without loss of the working load limit of the sling. The clevis allows easy connection to chain. Not recommended for use as bottom fitting of sling for back-hooking and reeving applications.

- Marked with single and double chain size, designation, grade, manufacture quality mark and Austlift branded.
- 25% higher work load limit than G80.
- Batch tested, test certificates available upon request.
- Fatigue tested > 20,000 times.

AS/NZS 3776 Certified G100 Alloy Steel Safety Factor 4-1 Size from (mm) 6-16

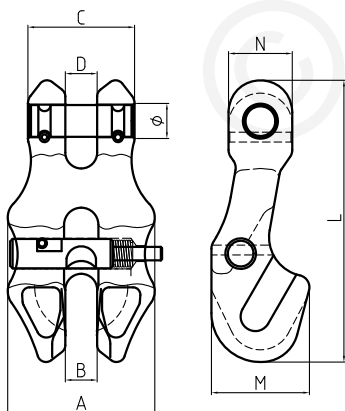

SIZE (mm)	CODE	WLL (T)	Wt. (kg)	DIMENSIONS (mm)							
				A	B	C	D	M	N	Ø	L
10	171210	4	0.75	60	11.7	43	11.7	45.4	26	13.3	115
13	171213	6.7	1.67	79	15	55	15	54	34	16.3	149
16	171216	10	4.2	98	19	70	19	70	40	19.7	184

Chain Sling WLL Tag

Austlift G100 safe work load tags are essential to identify a chain sling's lifting capacity together with other relevant information.

- Tags for single and multi lifting are available.
- Manufactured in 304 stainless steel material.

AS/NZS
3775

Certified

304
Stainless
Steel

Size from (mm)
8-22

SIZE	CODE	
	SINGLE	MULTI
8	090108SP	090208SP
10	090110SP	090210SP
13	090113SP	090213SP
16	090116SP	090216SP
20	090120SP	090220SP
22	090122SP	090222SP

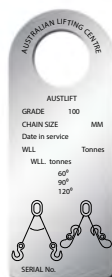

G100 Chain & Fittings

SPARE PARTS FOR G100 FITTING



Pin for Clevis Hook

SIZE (mm)	CODE	SUIT FOR PRODUCTS		
		CLEVIS SLING HOOK	CLEVIS SELF LOCK HOOK	CLEVIS GRAB HOOK
6	030606SP	SC-6-10	LC-6-10	GC-6-10
8	030608SP	SC-8-10	LC-8-10	GC-8-10
10	030610SP	SC-10-10	LC-10-10	GC-10-10
13	030613SP	SC-13-10	LC-13-10	GC-13-10
16	030616SP	SC-16-10	LC-16-10	GC-16-10
20	030620SP	SC-20-10	LC-20-10	GC-20-10
22	030622SP	SC-22-10	LC-22-10	GC-22-10



Safety Latch for Sling Hook

SIZE (mm)	CODE	SUIT FOR PRODUCTS	
		EYE	CLEVIS
6	030806SP	SE-6-10	SC-6-10
8	030808SP	SE-8-10	SC-8-10
10	030810SP	SE-10-10	SC-10-10
13	030813SP	SE-13-10	SC-13-10
16	030816SP	SE-16-10	SC-16-10
20	030820SP	SE-20-10	SC-20-10
22	030822SP	SE-22-10	SC-22-10



Pin and Stud for Chain Connector

SIZE (mm)	CODE	SUIT FOR PRODUCTS
6	030706SP	CL-6-10
8	030708SP	CL-8-10
10	030710SP	CL-10-10
13	030713SP	CL-13-10
16	030716SP	CL-16-10
20	030720SP	CL-20-10
22	030722SP	CL-22-10



Safety Trigger Kit for Self Locking Hook

SIZE (mm)	CODE	SUIT FOR PRODUCTS		
		EYE	CLEVIS	SWIVEL
6	030106SP	LE-6-10	LC-6-10	LS-6-10
8	030108SP	LE-8-10	LC-8-10	LS-8-10
10	030110SP	LE-10-10	LC-10-10	LS-10-10
13	030113SP	LE-13-10	LC-13-10	LS-13-10
16	030116SP	LE-16-10	LC-16-10	LS-16-10
20	030120SP	LE-20-10	LC-20-10	LS-20-10
22	030122SP	LE-22-10	LC-22-10	LS-22-10